

REL-DDT-12X36

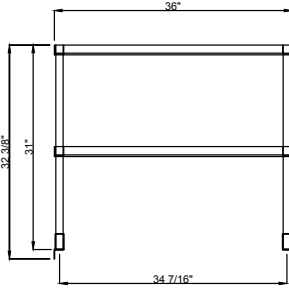

FRONT ELEVATION

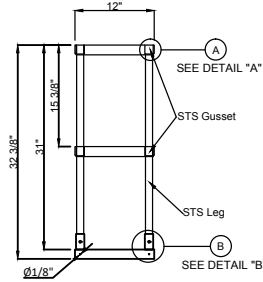

SIDE VIEW

- 18 GA. STAINLESS STEEL CONSTRUCTION.
- STS GUSSET AND STS LEG

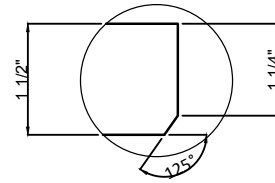

DETAIL "A"

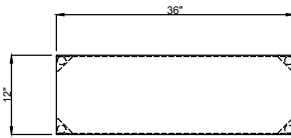

PLAN VIEW

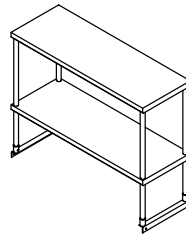

ISOMETRIC

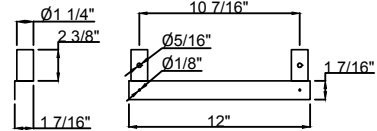

DETAIL "B"

REL-DDT-12X48

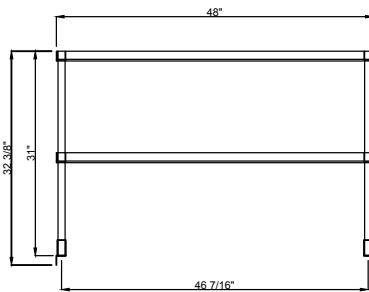

FRONT ELEVATION

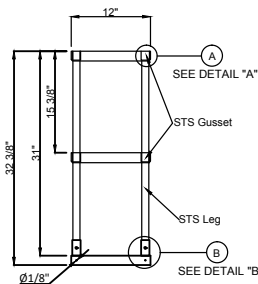

SIDE VIEW

- 18 GA. STAINLESS STEEL CONSTRUCTION.
- STS GUSSET AND STS LEG

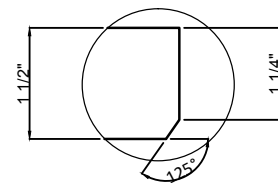

DETAIL "A"

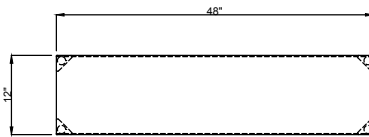

PLAN VIEW

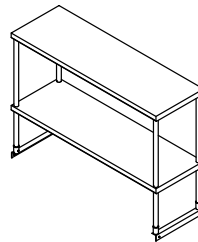

ISOMETRIC

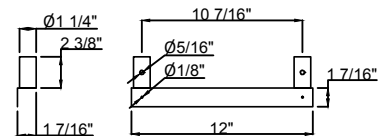

DETAIL "B"

Double Overshelves

Stainless Steel, Available in Two Widths and Four Lengths

REL-DDT-12X60

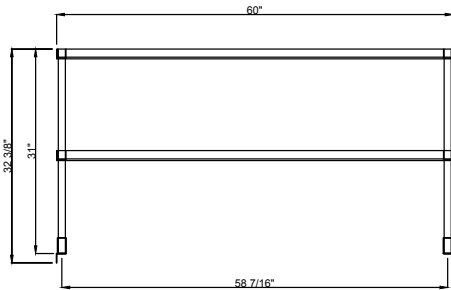

FRONT ELEVATION

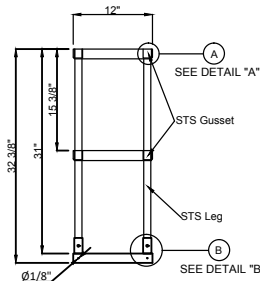

SIDE VIEW

- 18 GA. STAINLESS STEEL CONSTRUCTION.
- STS GUSSET AND STS LEG

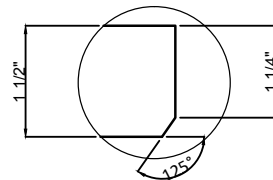

DETAIL "A"

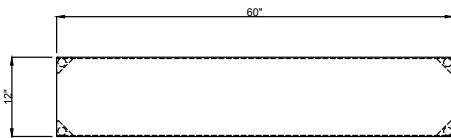

PLAN VIEW

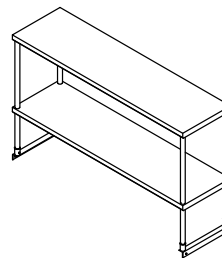

ISOMETRIC

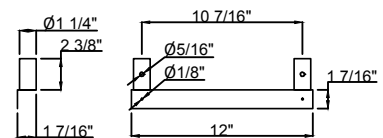

DETAIL "B"

REL-DDT-12X72

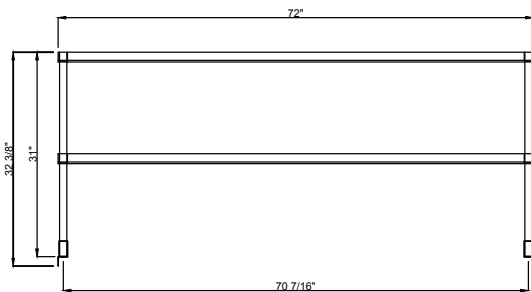

FRONT ELEVATION

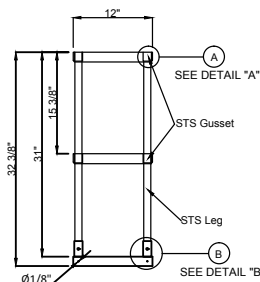

SIDE VIEW

- 18 GA. STAINLESS STEEL CONSTRUCTION.
- STS GUSSET AND STS LEG

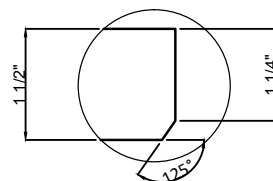

DETAIL "A"

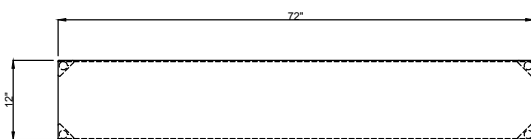

PLAN VIEW

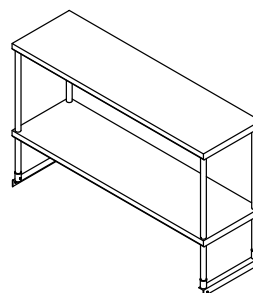

ISOMETRIC

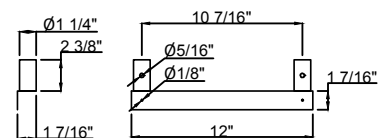

DETAIL "B"

REL-DDT-15X36

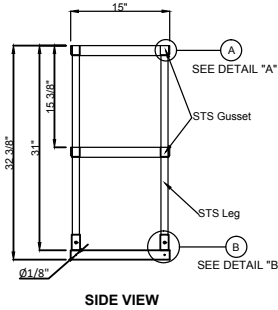
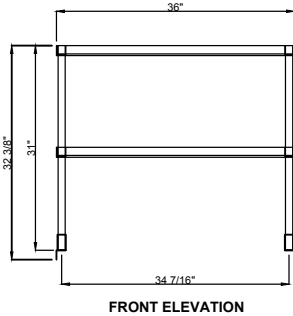

- 18 GA. STAINLESS STEEL CONSTRUCTION.
- STS GUSSET AND STS LEG

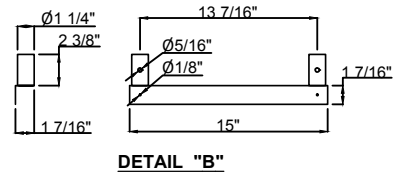
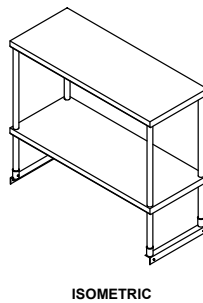
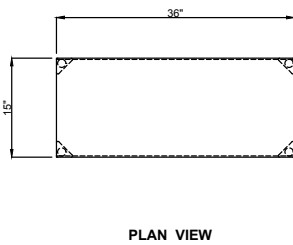
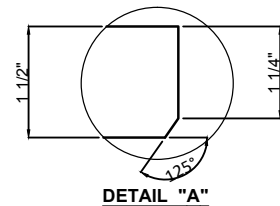

REL-DDT-15X48

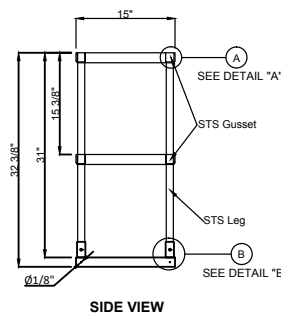
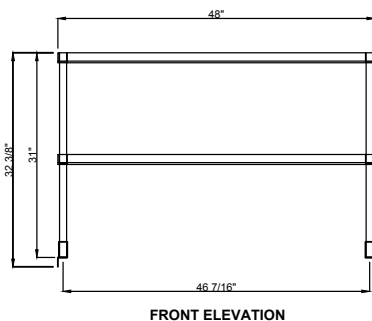

- 18 GA. STAINLESS STEEL CONSTRUCTION.
- STS GUSSET AND STS LEG

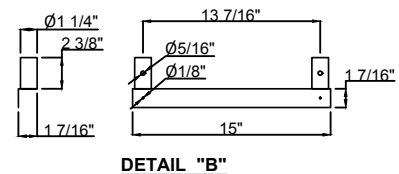
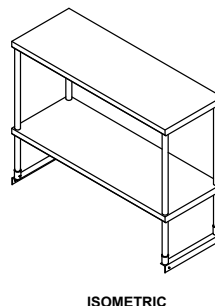
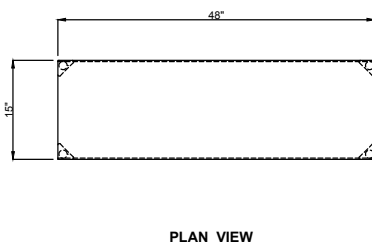
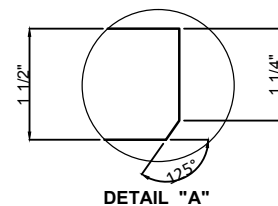

REL-DDT-15X60

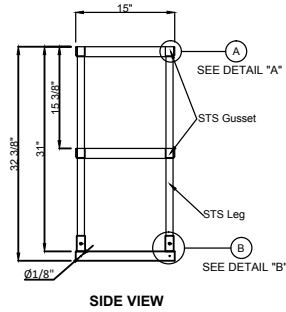
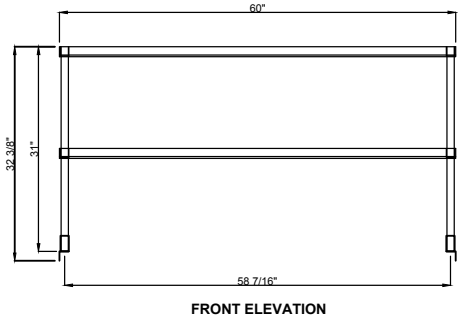

- 18 GA. STAINLESS STEEL CONSTRUCTION.
- STS GUSSET AND STS LEG

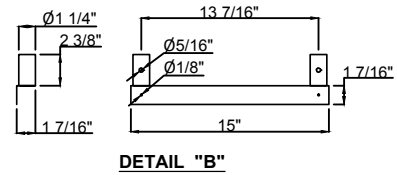
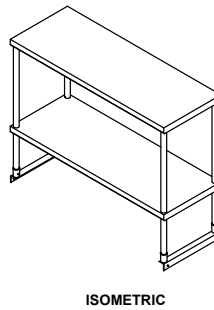
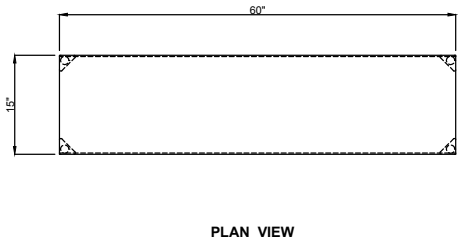
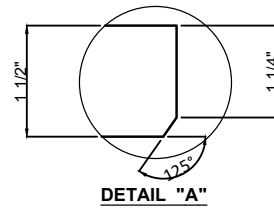

REL-DDT-15X72

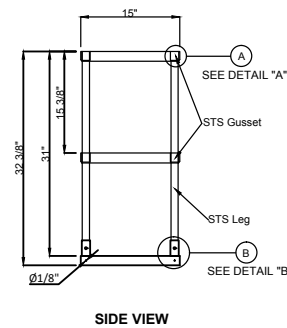
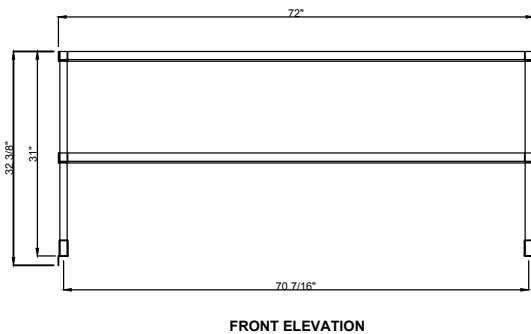

- 18 GA. STAINLESS STEEL CONSTRUCTION.
- STS GUSSET AND STS LEG

